



University Hospital

MAP

VERSION 4

Directions from University Hospital to:

Huntsman Cancer Institute and Clinical Neurosciences Center

Take the visitor elevators to Level 3.
Turn left out of the elevators and follow the signs.

Moran Eye Center and Primary Children's Medical Center

Use hallway on Level A, adjacent to the escalator.

Eateries

Cafeteria

Level A. Breakfast, lunch and dinner.
Hours: Mon.–Fri. 6:30 a.m. – 10 p.m.,
Sat.–Sun. and holidays 8 a.m. – 8 p.m.

Starbucks

Open 24 hours a day, 7 days a week.
Located on Level 1 near the lobby.

The Point Restaurant

Located on the sixth floor of the Huntsman Cancer Institute.
Open Mon.–Fri. Hours: breakfast 7 a.m. – 10:30 a.m., lunch 11 a.m. – 3 p.m.

The Point Bistro

Located on the sixth floor of the Huntsman Cancer Hospital.
Open Mon.–Fri. 7 a.m. – 8:30 p.m., Sat.–Sun. 11 a.m. – 7 p.m.

Valet Parking

Our free valet service is available to all patients and visitors, Mon.–Fri., 7 a.m. to 6 p.m.

Customer Service

We want you to have an excellent experience at University Hospital. If you have a concern about your care, please discuss it with your physician or nurse. We also have customer service team members available to help you. The Customer Service team provides support to resolve your concerns. They can also arrange interpreter services, photocopying, faxing, phone access, valet car service and concierge services for out-of-town visitors. You will find Customer Service at the information desks or the Customer Service office next to Starbucks. Or, call (801) 581-2668.



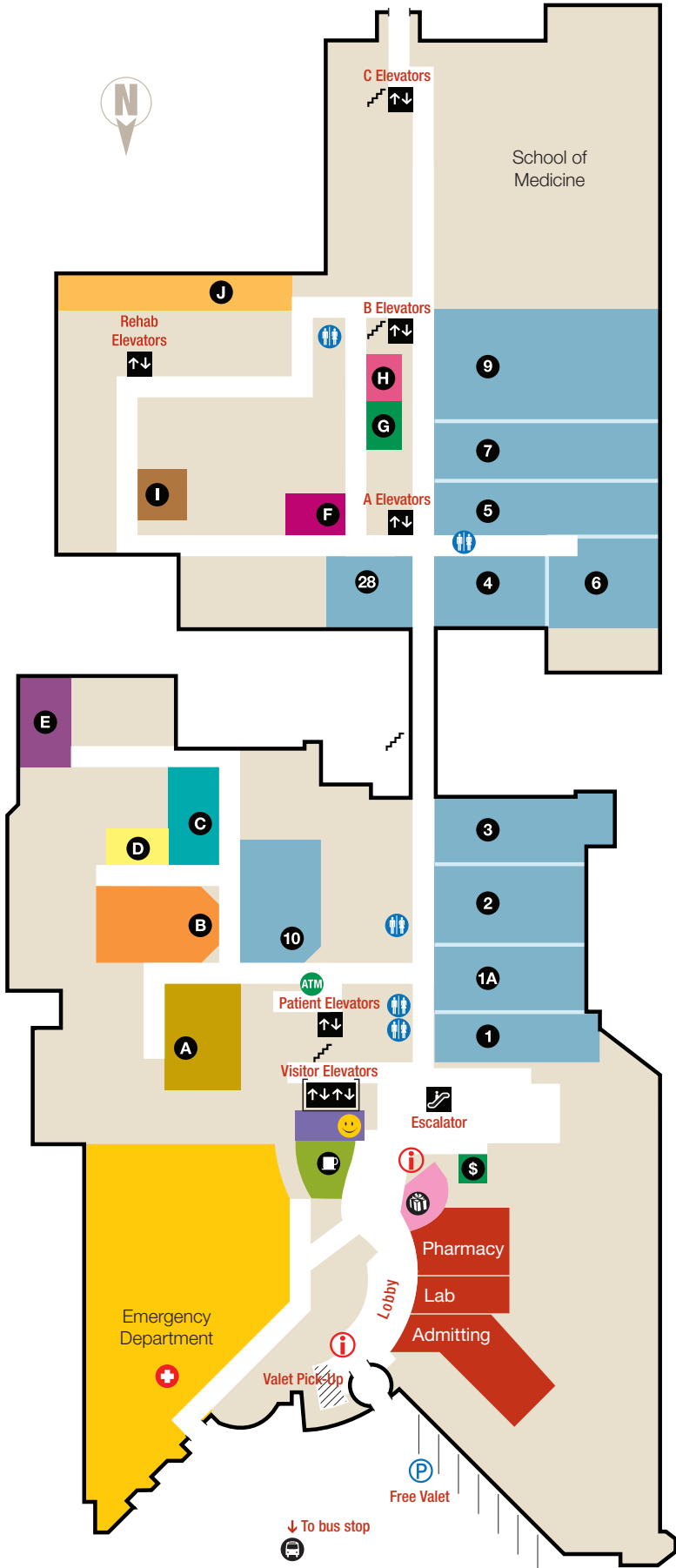

- Information
- Elevator
- Escalator
- Stairs
- Restrooms
- DVD rental
- ATM

Outpatient Clinics & Other Patient Services

- 1** Geriatrics Clinic/Infusion Center
- 1A** ID Clinic (Infectious Diseases)
- 2** Internal Medicine Clinic
- 2** Rheumatology Clinic
- 3** Pulmonary Clinic
- 3** Gastroenterology Clinic
- 4** OB/GYN Clinic
- 5** Surgery Clinic
- 6** Pediatrics Clinic
- 7** Dental Clinic
- 9** ENT/Audiology Clinic
- 9** Hearing Aid Services
- 10** Cardiovascular Center
- 28** Dermatology Clinic
- A** Emergency Care Unit
- B** Radiology (X-Ray)
- C** Echo Lab
- D** Radiology File Room
- E** MRI/Nuclear Medicine
- F** Interventional Radiology
- G** Mohs Surgery
- G** Medical Dermatology
- H** Alcohol & Drug Abuse Clinic
- I** Rehab Specialty Clinics
- J** Physical Medicine & Rehabilitation Clinic
- \$** Cashier
- Customer Service
- Emergency Department
- Gift Shop
- Starbucks
- Level A** Cafeteria (see map on reverse)
- Level A** Health Information (see map on reverse)
- Level A** Kidney/Liver Program (see map on reverse)
- Level A** Transplant Clinic (see map on reverse)

Level A

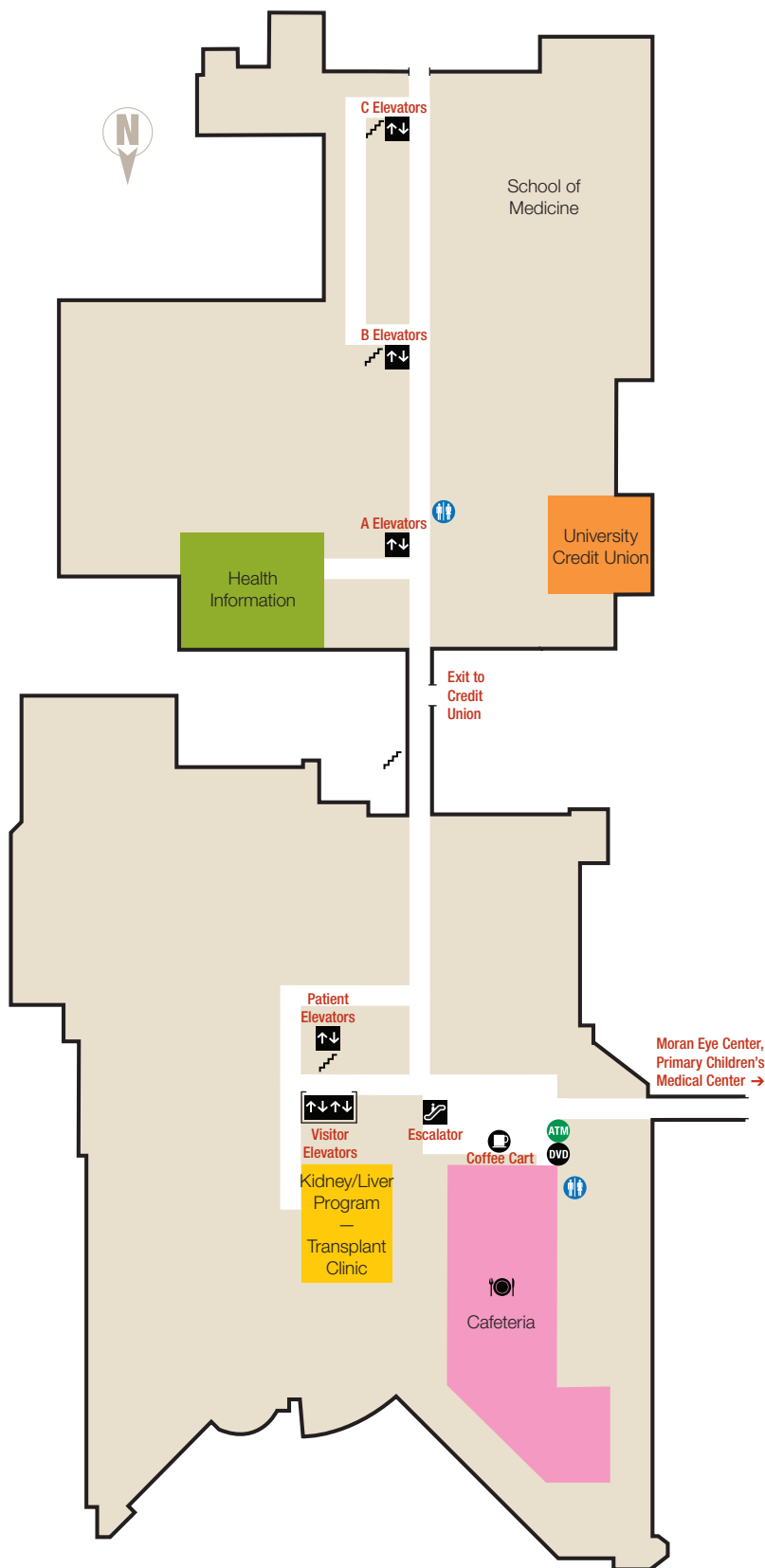

Services On Other Floors

- 5 West (Level 5)
- Acute Internal Medicine–A (Level 5)
- Acute Internal Medicine–B (Level 4)
- Acute Internal Medicine–C (Level 2)
- Bone Marrow Transplant (Level 5)
- Burn Center (Level 4)
- Burn Outpatient Clinic (Level 4)
- Cardiac Rehab (Level 4)
- Cath Lab (Level 4)
- Center for Clinical and Translational Science (Level 5)
- Cardiovascular Medical Unit (Level 4)
- Clinical Library (Level 4)
- Clinical Neurosciences Center (Level 3)
- Discharge Lounge (Level 3)
- EEG Lab (Level 3)
- Endoscopy (Level B)
- Enterostomal Therapy Nursing Services (Level 6)
- EP MRI Lab (Level 4)
- Heart Station (Level 4)
- Hope Chapel (Level 2)
- Huntsman Cancer Institute (Level 3)
- Inpatient Medical Rehab (Level 2)
- Intermediate Care Unit (Level 2)
- Labor & Delivery (Level 2)
- Maternal Fetal Diagnostic Center (Level 2)
- Maternal Newborn Care (Level 2)
- MICU/CCU (Level 4)
- Moran Eye Center (Level A)
- Neuro Acute Care (Level 3)
- Neuro Critical Care (Level 3)
- Newborn ICU (Level 2)
- Nursery (Level 2)
- OB Emergency Services (Level 2)
- OB/GYN Specialty Care (Level 2)
- OR 20 (Level 3)
- Ortho Trauma & Surgical Specialty (Level 6)
- Patient Rooms
 - 2000–2999 (Level 2)
 - 3000–3999 (Level 3)
 - 4000–4999 (Level 4)
 - 5000–5999 (Level 5)
 - 6000–6999 (Level 6)
- Pelvic Care Center (Level 3)
- Perinatal Genetics (Level 2)
- Primary Children's Medical Center (Level A)
- Pulmonary Lab (Level B)
- Respiratory Therapy (Level 2)
- Surgery (Level 3)
- Surgical Intensive Care (Level 2)
- Surgical Specialty & Transplant (Level 5)
- Urology (Level 3)

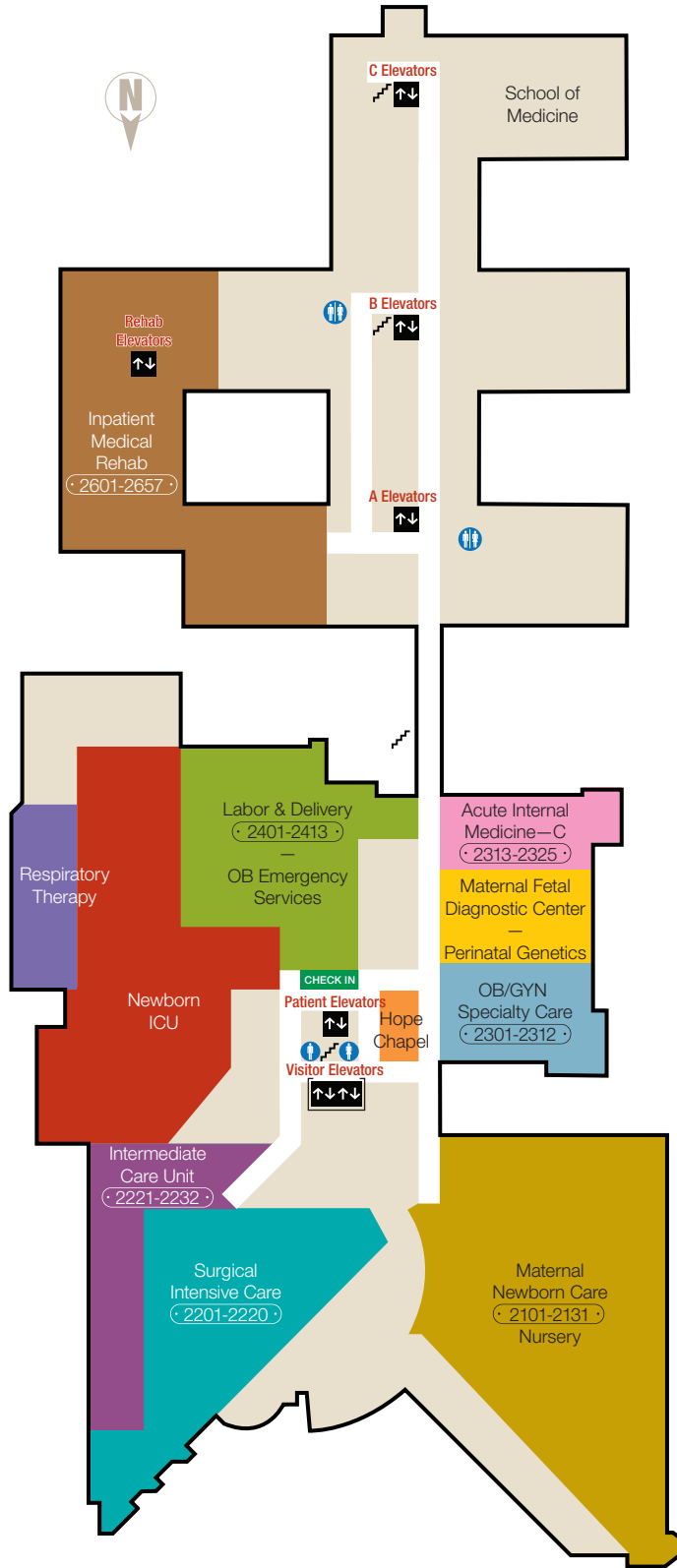

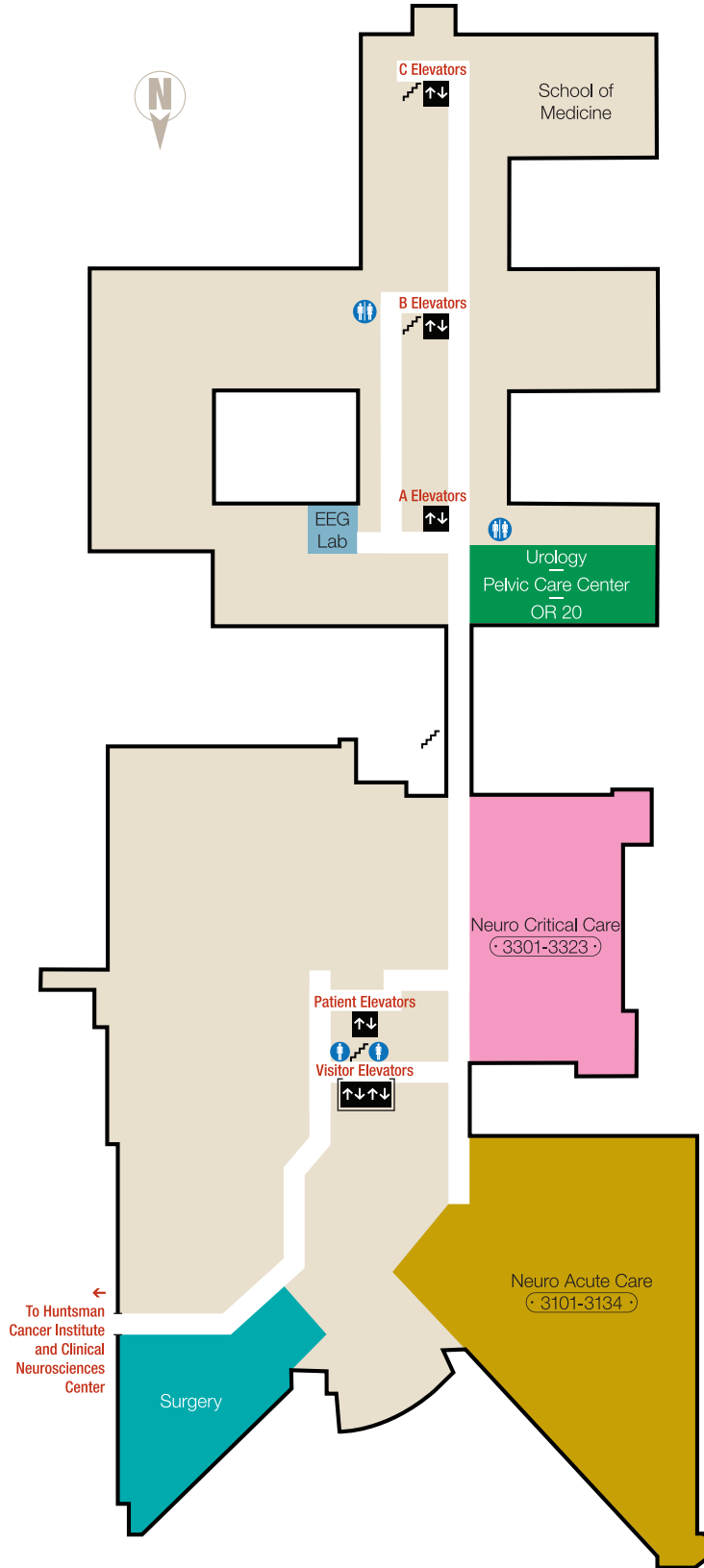

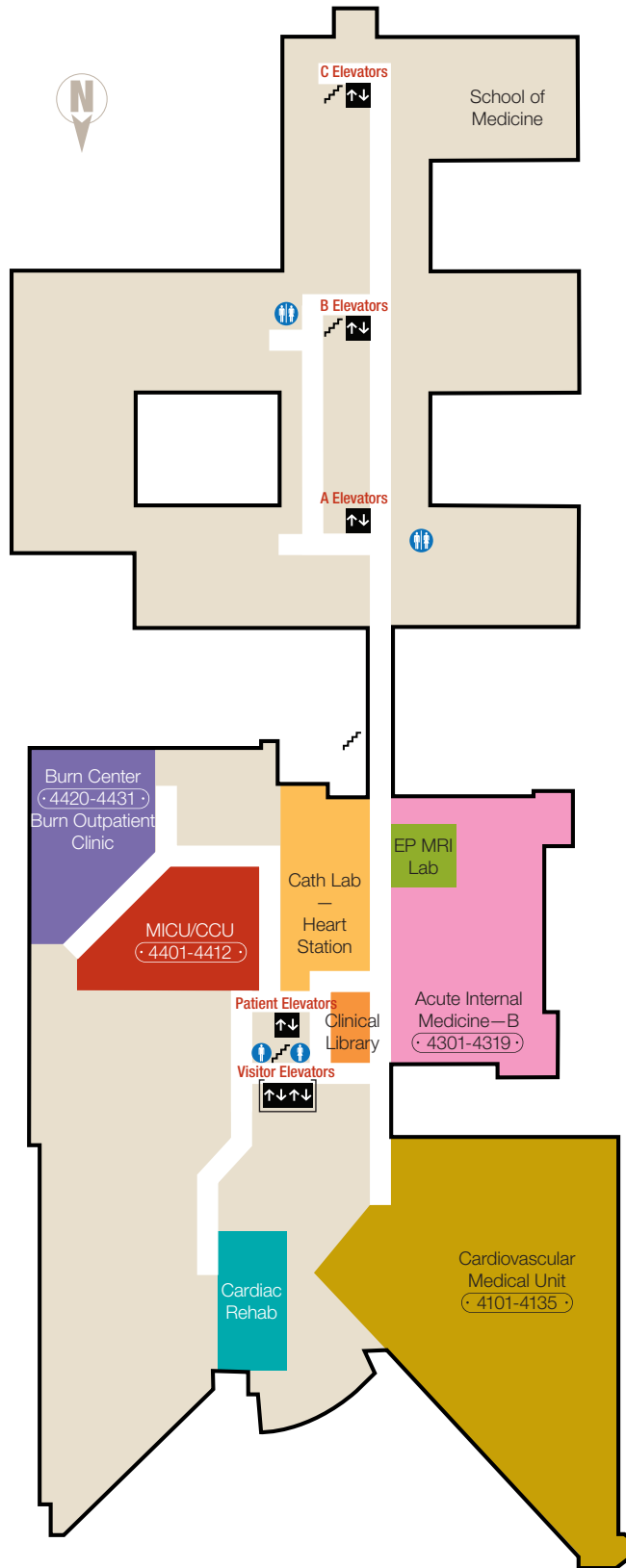

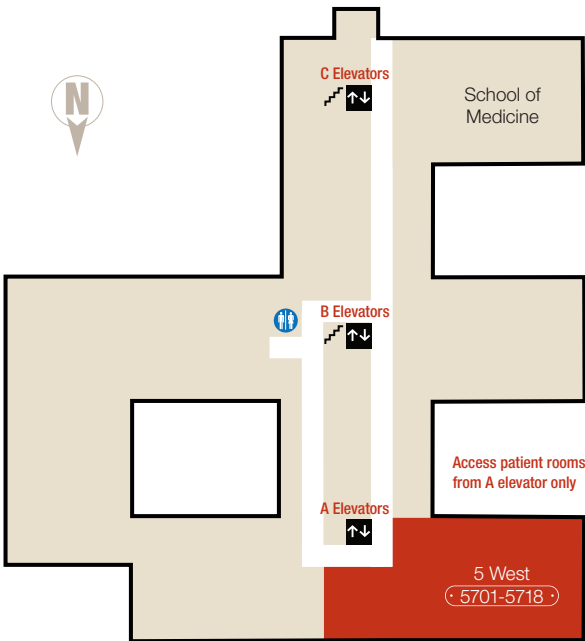

BUILDINGS ARE NOT CONNECTED

